

## 1. Structure diagram:

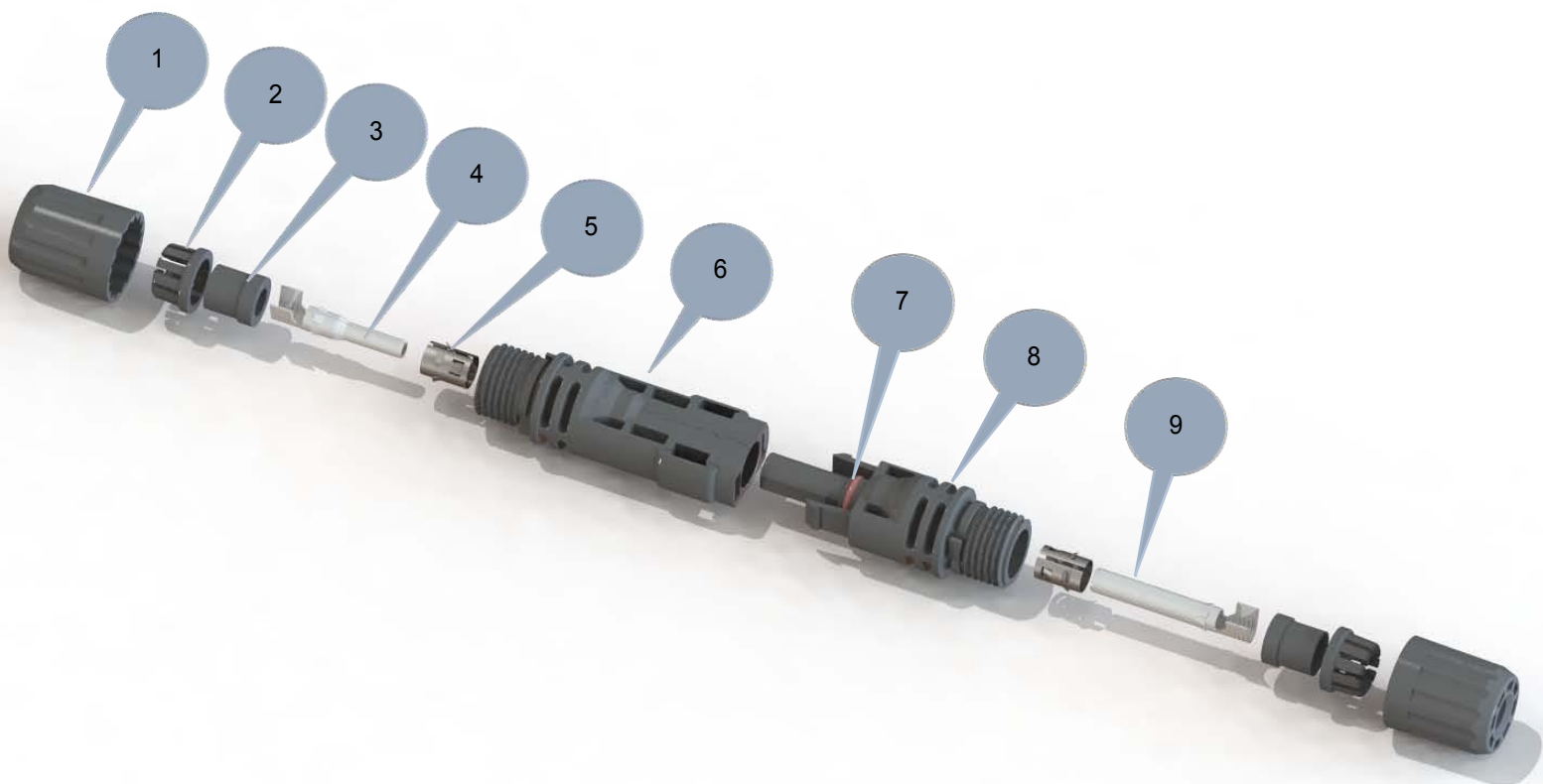

No.	Product Specifications	Quantity	Remark
1	Connector nut	2	
2	Cable clamp	2	
3	Cable clamp plug	2	
4	Metal negative pole	1	
5	Retreating circle	2	
6	Connector negative pole	1	
7	O Seal ring	1	
8	Connector Positive pole	1	
9	Metal Positive pole	1	

## 2. Connector Size

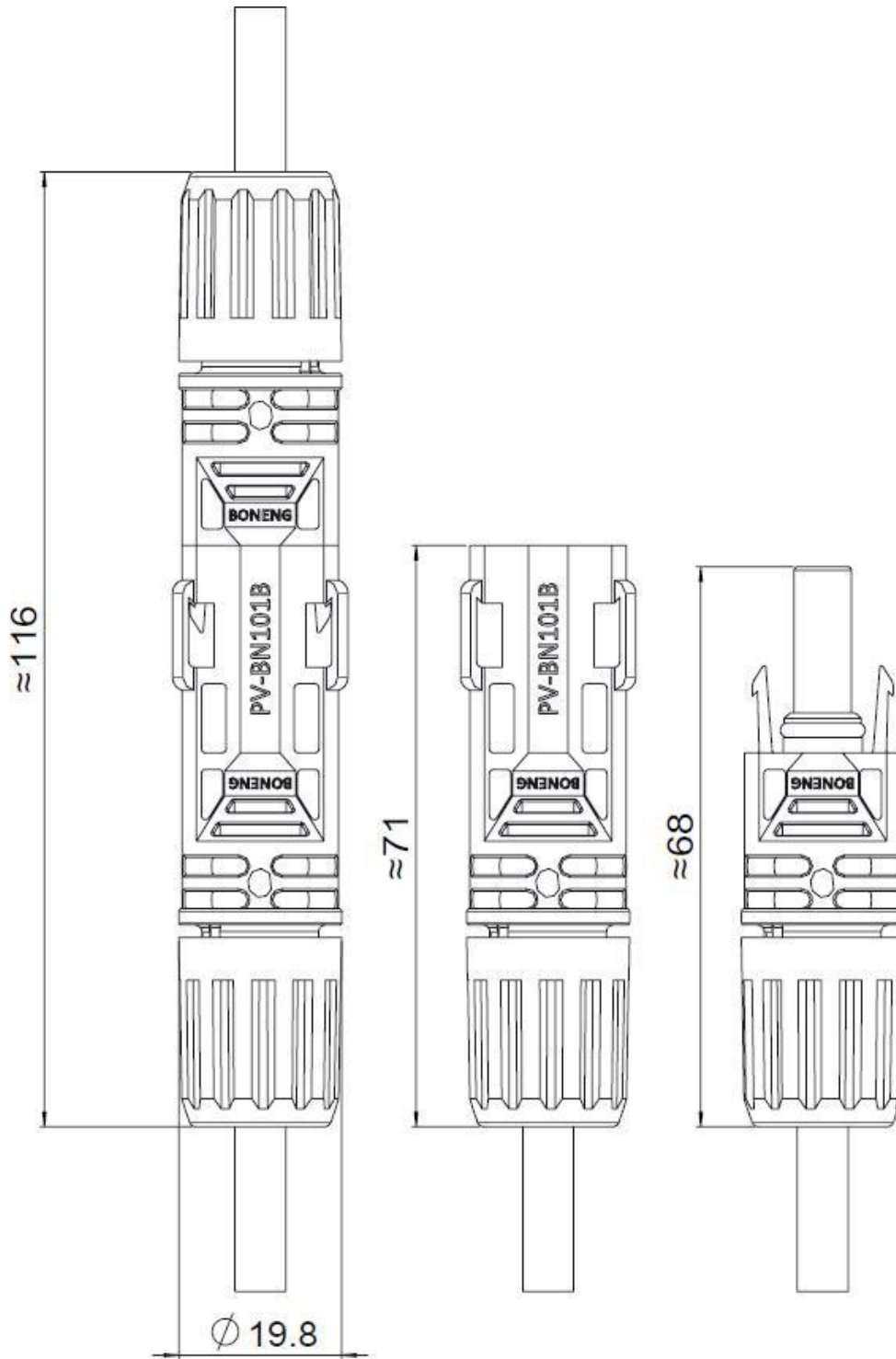

### 3. Specifications

NO.	Items	Performance parameters or requirements
1	Maximum operating voltage	DC1500V
2	Maximum operating current	30A
3	Degree of protection	IP67
4	Security Classification	Class II
5	Application Classification	Class A
6	Use Temperature	-40°C ~ +85°C
7	Cable line locking total tension	310N tension stable 1min, Displacement≤2mm
8	Connector interlocking force	≥125N
9	Terminal connection force	2.5mm <sup>2</sup> cable: ≥230N; 4mm <sup>2</sup> cable: ≥310N
10	Cable locking force	250N force retention 1min, Displacement≤2mm
11	Low temperature mechanical stability	5 hours at -40 ° C ± 2 ° C, make the impact to the connector of 1J 4 times, the connector is not damaged
12	Wet leakage current	Insulation resistance≥400MΩ
13	Withstand voltage	AC8000V, stable 1min, No breakdown

## 4. Inspection and testing standards

- 1) The plastic parts of the connector are free from scratches, damages, etc., and the surface is clean and free of deformation and burrs.
- 2) The connector metal parts have no defects of oxidation and deformation.
- 3) The connector male and female models and markings are clear.
- 4) The connector O-ring is not loose or damaged.

The connector Retreating circle without deformation, rust, and is assembled in place.